

76184800

MODERN 2-BEDROOM APARTMENT IN EMBA

 Emba, Paphos

€355,000 +VAT



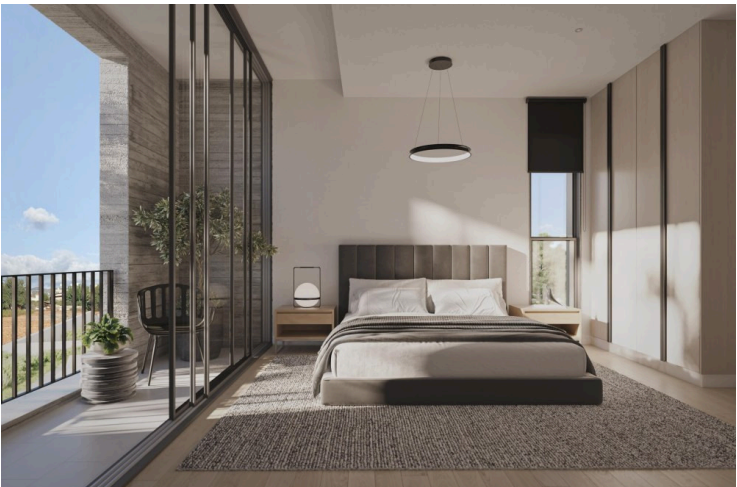

Overview

Specifications

Bedrooms

 2

Bathrooms

 2

Covered

 80 m²

Type	Apartment
------	-----------

Showers	2
---------	---

Toilets	2
---------	---

Covered veranda	8.4 m ²
-----------------	--------------------

Status	Off plan
--------	----------

Description

This 2-bedroom apartment in the charming village of Emba combines contemporary design with peaceful surroundings. Ideal for couples, small families, or professionals, it offers a comfortable and stylish living space. The development also includes a selection of modern villas, providing a variety of housing options in the same serene location.

Apartment Features:

2 spacious bedrooms with abundant natural light

2 modern bathrooms with high-quality finishes

Open-plan living and dining area

Fully equipped modern kitchen

Private balcony or veranda for outdoor relaxation

Allocated parking and access to communal gardens

Location:

Located in the heart of Emba, the apartment and villas offer a quiet, suburban lifestyle while remaining a short drive from Paphos city center and essential amenities such as shops, schools, restaurants, and leisure facilities.

Quality & Comfort:



Additional information

Facilities

Elevator

Gym

Parking, Covered

Pool, Communal

Sauna

Features

Entrance gate

Pool bar

Distances

Amenities



1.2 km

Airport



19 km

Sea



2.7 km

Schools



500 m

Contact us



Olga Dietrich

 (+357) 96701022

 o.dietrich@vivorealty.com.cy

