



**VIVO**  
REALTY



## SERVICED OFFICE SPACE IN THE HEART OF CITY CENTRE

 **Limassol, Petrou & Pavlou**

**64181080**



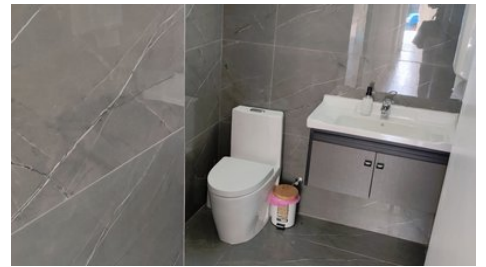
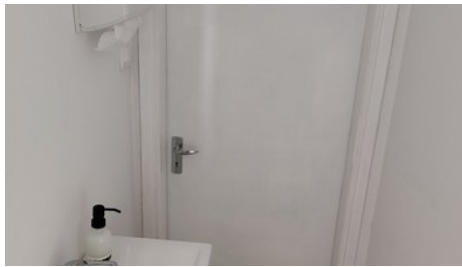
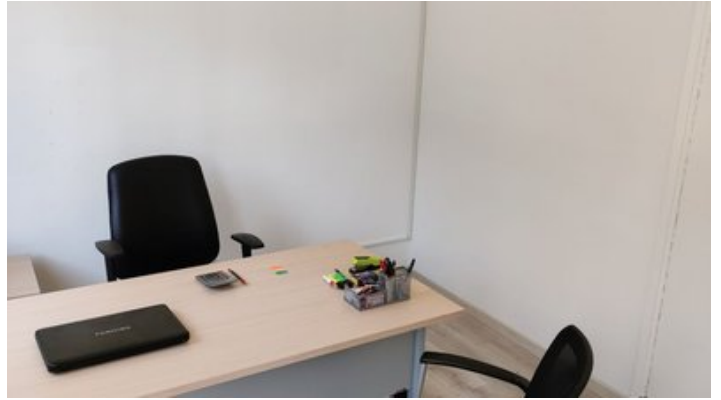

|                                 |                           |               |                  |
|---------------------------------|---------------------------|---------------|------------------|
| <b>Rent</b>                     | €550 +VAT /month          | <b>Type</b>   | Office           |
| <b>Covered</b>                  | 15 m <sup>2</sup>         | <b>Status</b> | Key ready        |
| <b>Energy efficiency rating</b> | exempt                    | <b>Floor</b>  | Ground floor / 1 |
| <b>Area</b>                     | Limassol, Petrou & Pavlou |               |                  |

---

## Description

Office suite of 15m2 situated in the heart of Limassol, close to the Era Apollon, ideal for companies wishing to rent small Fully-Furnished office spaces. ALL the utility bills and common expenses are included in the rent.

- \* Fully furnished premises, including desks, chairs, filling cabinets.
- \* Electricity, water and common expenses included in the rent, for the whole duration of the rental agreement
- \* Fully air conditioned
- \* Can be your registered office address
- \* Common lounge area.



### Tatiana Kirshanova

Property Consultant

✉ tatianak@vivorealty.com.cy

☎ (+357) 96071790

## Facilities

Aircondition, Split system

---

## Features

Heart of city center

Lobby

Closed offices

Near public transport

Furnished office

Near amenities

Kitchen

Easy access to main roads

Business facilities

Lounge area

Printer

Near bus route

Internet