

2181770

RESIDENTIAL PLOT OF 586m² NEAR TO RIGA FEREOU STR

 Chalkoutsa, Limassol

€1,500,000

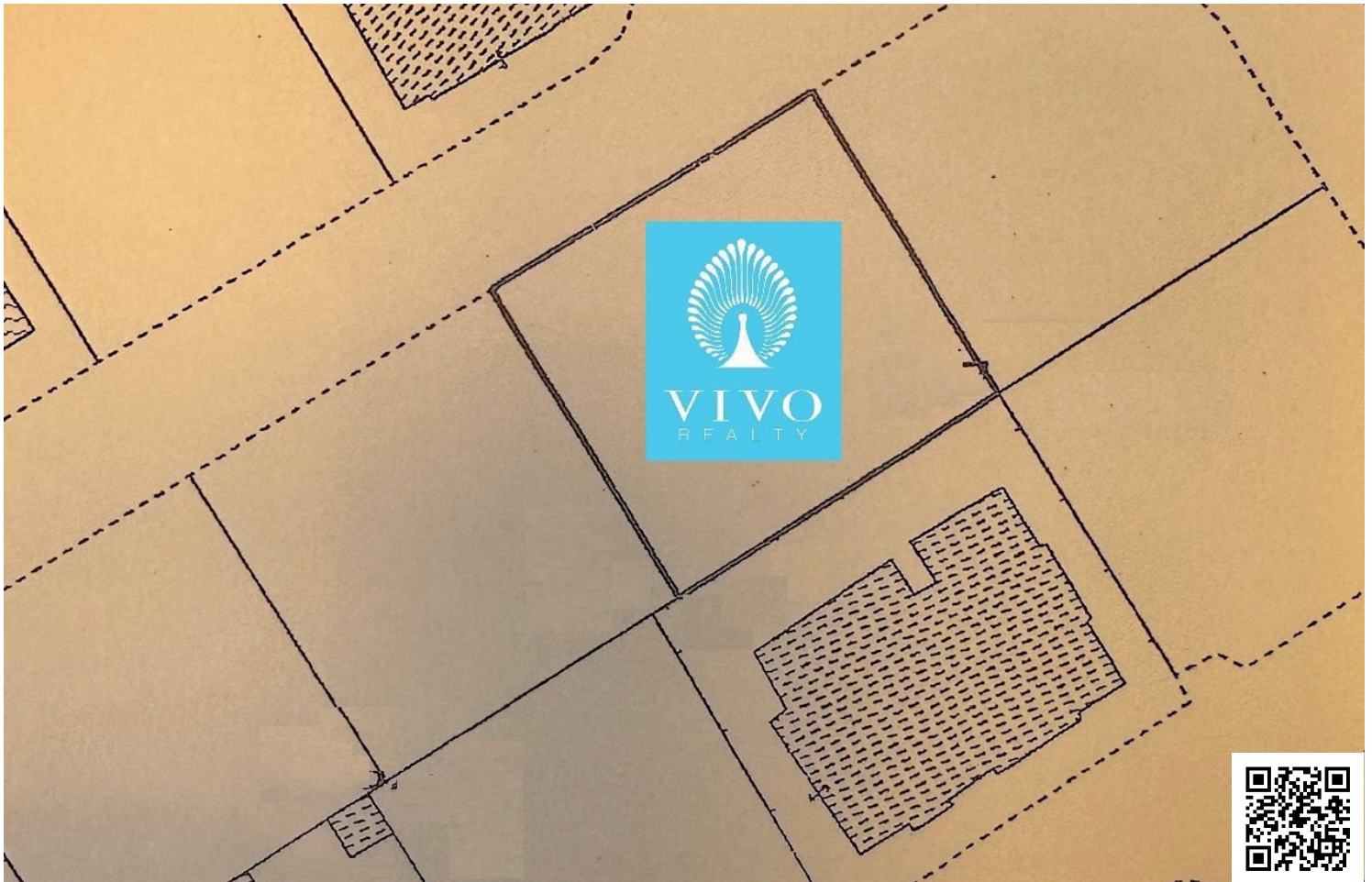



Overview

Specifications

Area

 586 m²

Type

Building Plot

Title deed

Yes

Description

An excellent opportunity for those who want a plot of land in one of the best areas of Limassol in the center and close to Riga Fereou Street.

It is a residential plot of 586sqm with building density 120% and coverage 50%.

The location of the plot is ideal for the construction of an apartment building. Note, within the plot there is a 5-bedroom house that will have to be demolished for the construction of a building.

The excellent location of the plot presents a unique opportunity for anyone who wants to invest in a property in a desired area. Don't miss this opportunity. It is advertised by Vivo Realty and we are here to help you with all your real estate needs.



Additional information

Features

Connected to electric mains

Easy access to highway

Easy access to main roads

Heart of city center

Investment opportunity

Near amenities

Quiet area

Planning zones

Zone	Cover factor	Build factor	Max height	Max floors	Affected percentage
Ka4	120%	50%	13.5 m	3	-

Contact us



Roula J. Andreou

 (+357) 96650308

 rjalim1@vivorealty.com.cy

